

INSTRUMENTATION CALIBRATION/TEST SHUTOFF VALVES

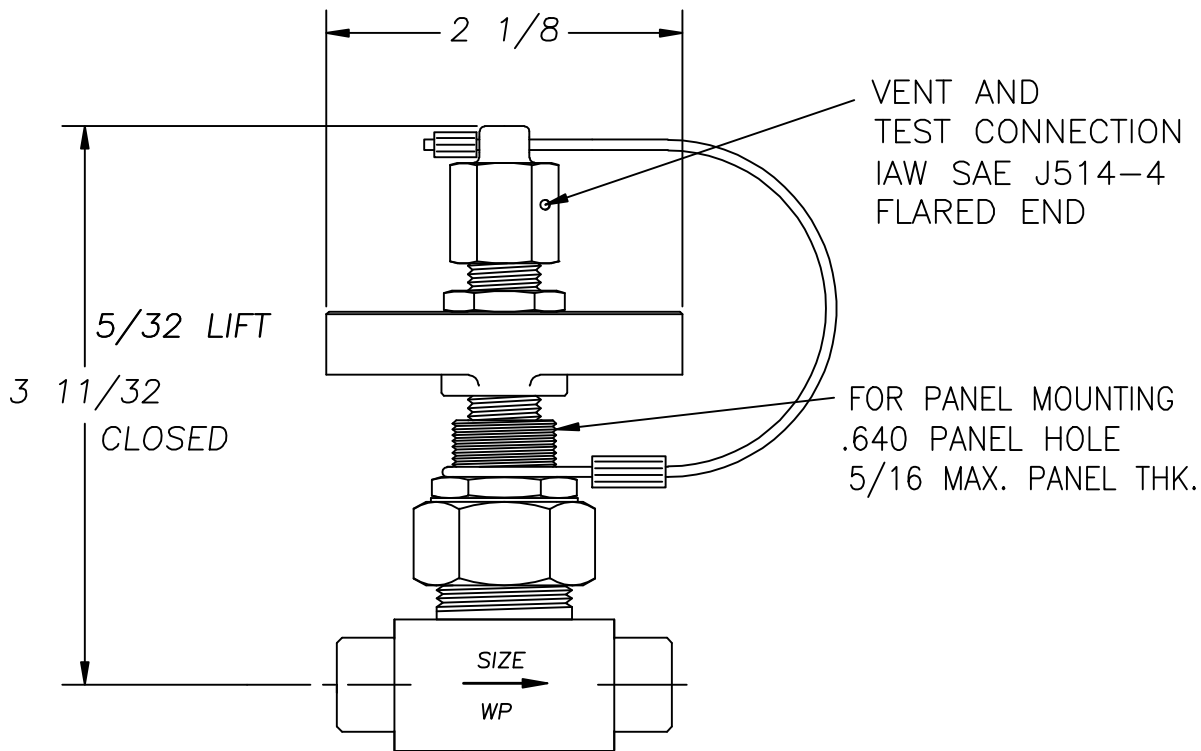

STANDARD END CONNECTIONS SHOWN

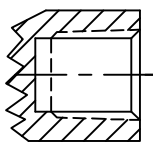

1/4-18 FNPT

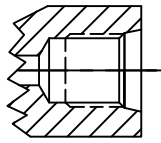

7/16-20 FEMALE
STR THDS.

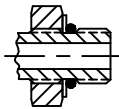

7/16-20 MALE
ADJ STR THDS.

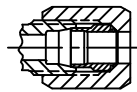

1/4 OD BITE
TYPE ENDS

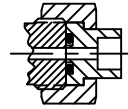

1/4 OD SW
UNION ENDS

- THE END CONNECTIONS SHOWN CAN BE PROVIDED ON BOTH ENDS OF VALVE OR CAN BE ANY COMBINATION OF THOSE SHOWN.
- FOR FACE TO FACE DIMENSIONS CONSULT GENERAL CATALOG PAGES.
- INLINE AND ANGLE CONFIGURATIONS AVAILABLE. CONSULT CATALOG PAGES.
- ADDITIONAL SIZES AND CONFIGURATIONS AVAILABLE, CONSULT FACTORY.
- STANDARD MATERIALS; 316SS AND NICU. OTHER MATERIALS UPON REQUEST.
- TEMPERATURE RANGE; -90°F, +600°F.

DERBYSHIRE MARINE PRODUCTS LLC, HARLEYSVILLE, PA 19438

TEL: 267-222-8900, FAX: 267-222-8865

Web: www.derbyshiremp.com

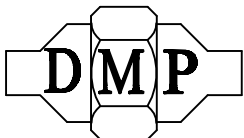

"GET THE CONNECTION"

INSTRUMENTATION CALIBRATION/TEST SHUTOFF VALVES

APPLICATIONS:

- WHETHER YOUR APPLICATION IS IN THE PHARMACEUTICAL, REFINING, NUCLEAR, PETROLEUM, CHEMICAL, POWER GENERATION, OR OTHER LIQUID OR GAS CONTROL SYSTEMS, THE NEED FOR VALVES IN PRESSURE INSTRUMENT MONITORING IS CLEAR. EQUALLY AS CLEAR IS THE FACT THAT THE PROPER CALIBRATION AND INSPECTION ON CONTROL SYSTEMS REQUIRES INSTRUMENT VALVES THAT DELIVER PRECISION ENGINEERED PERFORMANCE, RELIABILITY WITH COST EFFICIENCY.
- NOW AVAILABLE FOR THE COMMERCIAL INDUSTRY, DERBYSHIRE MARINE INSTRUMENT VALVES OFFER UNSURPASSED HIGH QUALITY AS A RESULT OF RIGOROUS QUALIFICATION TESTING REQUIRED BY MILITARY SPECIFICATION.
- DERBYSHIRE MARINE'S INSTRUMENT VALVES ARE OF A SIMPLIFIED DESIGN, PROVIDING A CONSTRUCTION WHICH OFFERS HIGH RELIABILITY FOR LIQUIDS OR GASES AT PRESSURES UP TO 6000PSI AT TEMPERATURES FROM -90° F TO +600° F.
- EACH VALVE IS CONSTRUCTED FROM THE HIGHEST QUALITY MATERIALS, IN ACCORDANCE WITH MILITARY SPECIFICATIONS. STANDARD MATERIALS FOR THE BODY, BONNET AND STEM ARE EITHER STAINLESS STEEL OR NICKEL COPPER ALLOY. THE VALVE DESIGNS HAVE ALL PASSED A SERIES OF HI SHOCK AND VIBRATION TESTS. EACH VALVE IS HYDROSTATICALLY TESTED FOR SEAT TIGHTNESS AND STRUCTURAL SOUNDNESS PRIOR TO SHIPPING.
- THE VALVES SUPERIOR DESIGN INCLUDES LOW TORQUE OPERATION. THE METAL TO METAL BACK SEAT CHARACTERISTIC PREVENTS THE STEM FROM BACKING OUT FROM THE VALVE BODY.

DERBYSHIRE MARINE PRODUCTS LLC, HARLEYSVILLE, PA 19438

TEL: 267-222-8900, FAX: 267-222-8865

Web: www.derbyshiremp.com

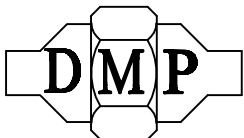

"GET THE CONNECTION"