

UNION – TUBE TO TUBE (WELD OR BRAZE)

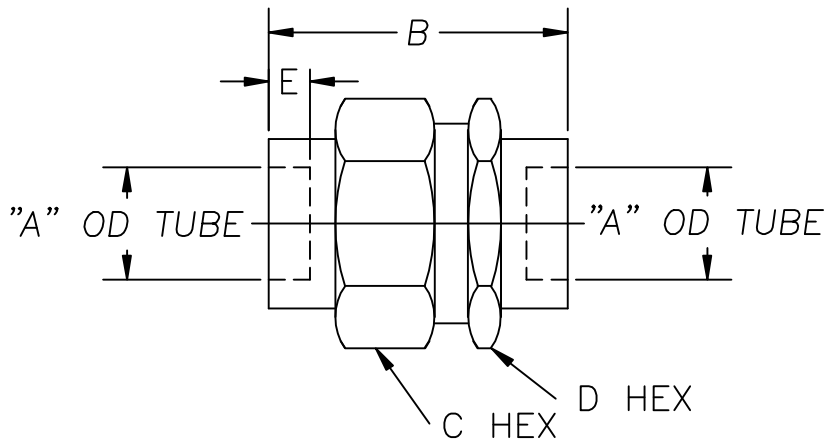

MT300 SERIES

PART NO.	A OD	B	C-HEX	D-HEX	E
MT300-4	1/4	1"	5/8	5/8	3/16
MT300-6	3/8	1 1/4	13/16	3/4	1/4
MT300-8	1/2	1 7/16	15/16	7/8	5/16
MT300-10	5/8	1 11/16	1 1/8	1 1/16	3/8
MT300-12	3/4	1 15/16	1 3/8	1 3/8	7/16
MT300-16	1"	2 3/16	1 5/8	1 5/8	1/2
MT300-20	1 1/4	2 5/16	2"	1 7/8	9/16
MT300-24	1 1/2	2 1/2	2 3/8	2 1/4	5/8
MT300-32	2"	3"	3 1/8	3"	7/8

- STANDARD MATERIALS: STAINLESS STEEL, NICU, STEEL AND 70/30 CUNI. OTHER MATERIALS AVAILABLE UPON REQUEST. 3000 PSI WORKING PRESSURE.
- REDUCING FITTINGS AVAILABLE, CONSULT FACTORY.
- FOR PIPE (IPS) SOCKET FITTINGS SEE SECTION MP300.
- METRIC SIZES AVAILABLE, CONSULT FACTORY.
- FOR ADDITIONAL INFORMATION SEE MT ENGINEERING DATA SHEETS.
- DIMENSIONS SUBJECT TO CHANGE WITHOUT NOTICE.

DERBYSHIRE MARINE PRODUCTS LLC, HARLEYSVILLE, PA 19438

TEL: 267-222-8900, FAX: 267-222-8865

Web: www.derbyshiremp.com

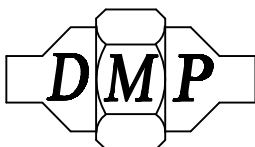

"GET THE CONNECTION"